

Fabric Art Assembly Instructions

All pre-cut frame kits are cut as 2" outer borders and 1/2" accent borders. The outside border overlaps the inside accent border by 3/8" for the small butterflies and 1/4" for the medium butterflies, showing 1/8" and 1/4" respectively. Regardless of frame size and butterfly size, the preparation, cutting, and assembly is the same. The diagrams show the borders for the small butterflies 1/8" accent border. Frame sizes smaller than 11" x 19" are completely laser-cut and laser-drawn. Frame sizes greater than 10" x 19" are partly laser-cut and laser-drawn and partly manually cut and drawn.

Kit Contents

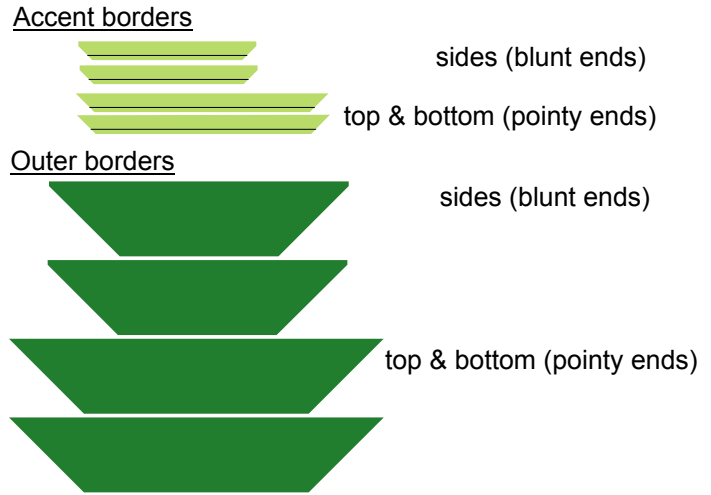
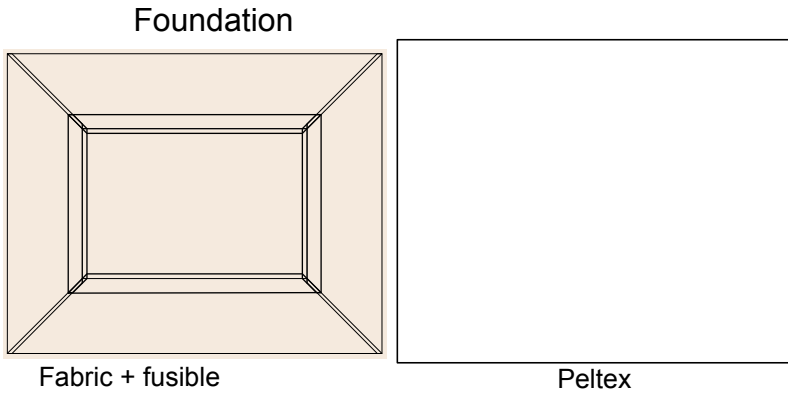

Design Plan

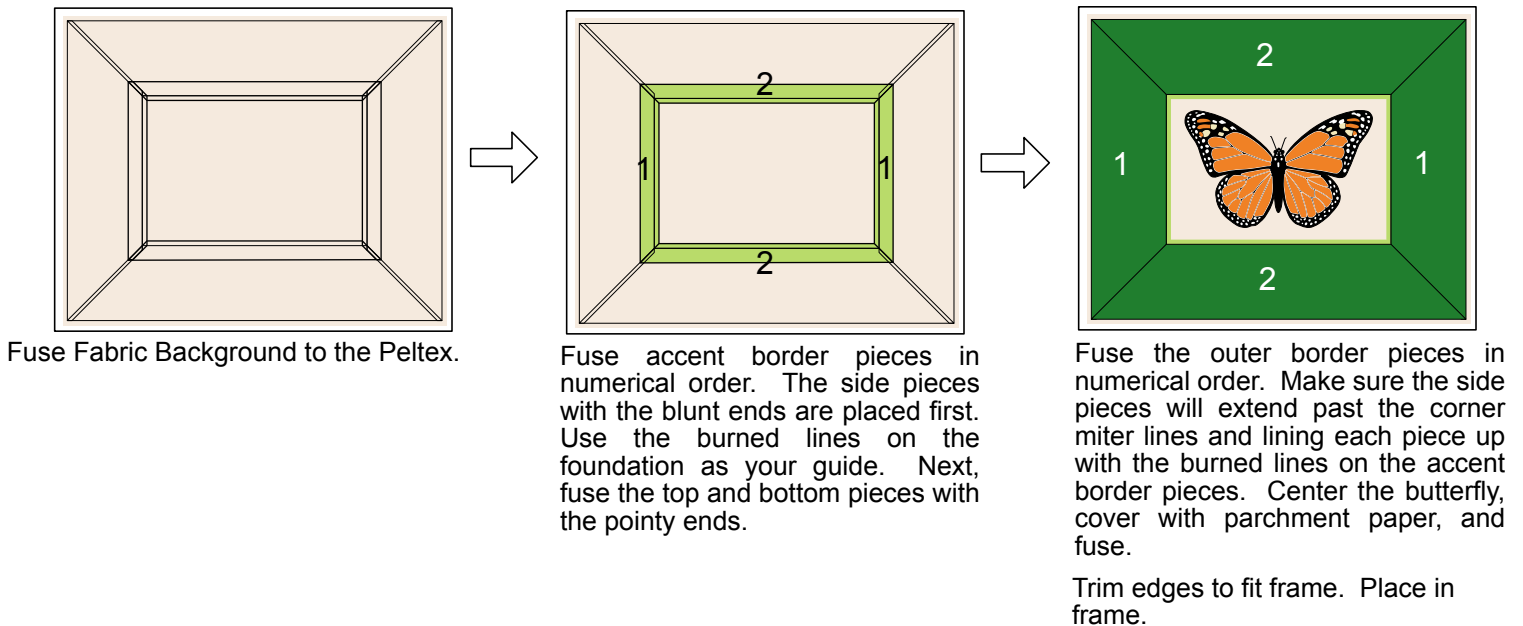

| Butterfly Size | Number of Butterflies | Background and Peltex | Accent Borders | | Outer Border | |
|----------------|-----------------------|-----------------------|----------------|-------|-------------------|----|
| | | | (2 each) 0.5" | | (2 each) 2" width | |
| Small | 1 | 10 x 8 | 6.75 | 4.75 | 10 | 8 |
| | 2 | 11 x 14 | 7.75 | 10.75 | 11 | 14 |
| | 3 | 11 x 17 | 7.75 | 13.75 | 11 | 17 |
| | 4 | 10 x 20 | 6.75 | 16.75 | 10 | 20 |
| Medium | 1 | 14 x 11 | 10.5 | 7.5 | 14 | 11 |
| | 2 | 14 x 18 | 10.5 | 14.5 | 14 | 18 |
| | 3 | 14 x 22 | 10.5 | 18.5 | 14 | 22 |
| | 4* | 14 x 28 | 10.5 | 24.5 | 14 | 28 |

*Requires custom framing

Fabric Art Make Your Own

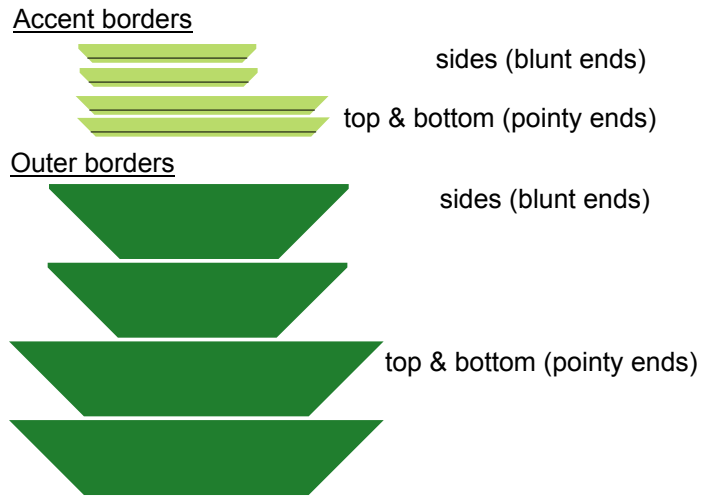
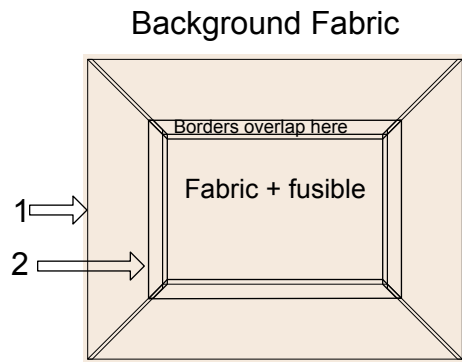

All pre-cut frame kits are cut as 2" outer borders and 1/2" accent borders. The outside border overlaps the inside accent border by 3/8" for the small butterflies and 1/4" for the medium butterflies, showing 1/8" and 1/4" respectively. Regardless of frame size and butterfly size, the preparation, cutting, and assembly is the same. The diagrams show the borders for the small butterflies showing a 1/8" accent border.

If you are not using a pre-cut kit, make your own foundation and borders using the following directions:

The stated frame size is the size of the frame opening measured from the backside. The frame opening from the front side will be between 3/8 and 3/4 inch smaller so the art work does not fall out.

These directions are based on the stated frame size. Cut a piece of background fabric, Heat n Bond Ultrahold, and Peltex, that is 1/2 inch larger than the frame size. It will be trimmed later.

Using a mechanical pencil, draw a rectangle that outlines the frame (rectangle 1).

Place the butterfly or butterflies on the background and decide where you want the accent border to start. Plan out how wide you want the accent and outer border. The accent border will go under the outer border so it will need to be cut wider than what will show.

Measuring from rectangle 1, draw rectangle 2 which is the outline of the inside border. Subtract the overlap amount from the outer border width to determine where to draw the rectangle. These are the only lines you need for the placement of the borders. The pencil lines will not show.

Prepare enough fabric with Heat n Bond Ultrahold fused to the backside of the fabric. Cut the borders as follows:

Top and Bottom



Cut 2 strips the width of the desired border. Trim the length to match the width of the drawn rectangle. Trim the ends at 45° angle starting at the bottom corner.

Sides



Cut 2 strips the width of the desired border. Trim the length to match the length of the drawn rectangle. Trim the ends at 45° angle starting at about 1/4 inch from the bottom corner.

Follow assembly instructions. Trim edges to fit frame. Place in frame.